

dc Motor Dimensions

Refer to dimension tables on page 50.

Type 3300P Motors

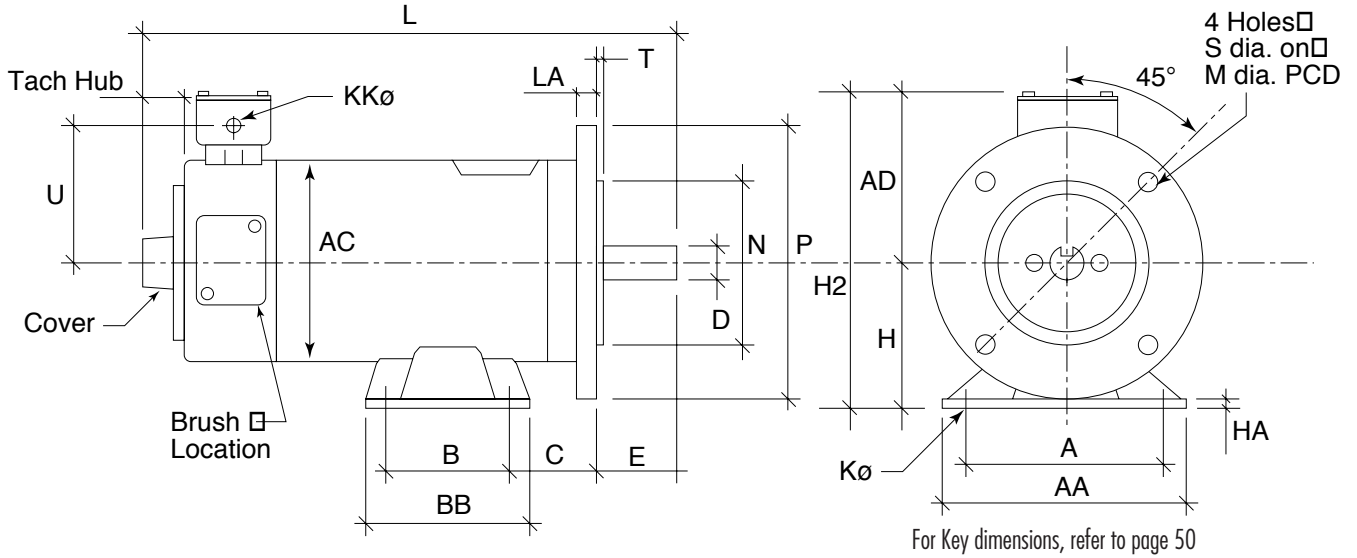

Type 3400P and 3500P Motors

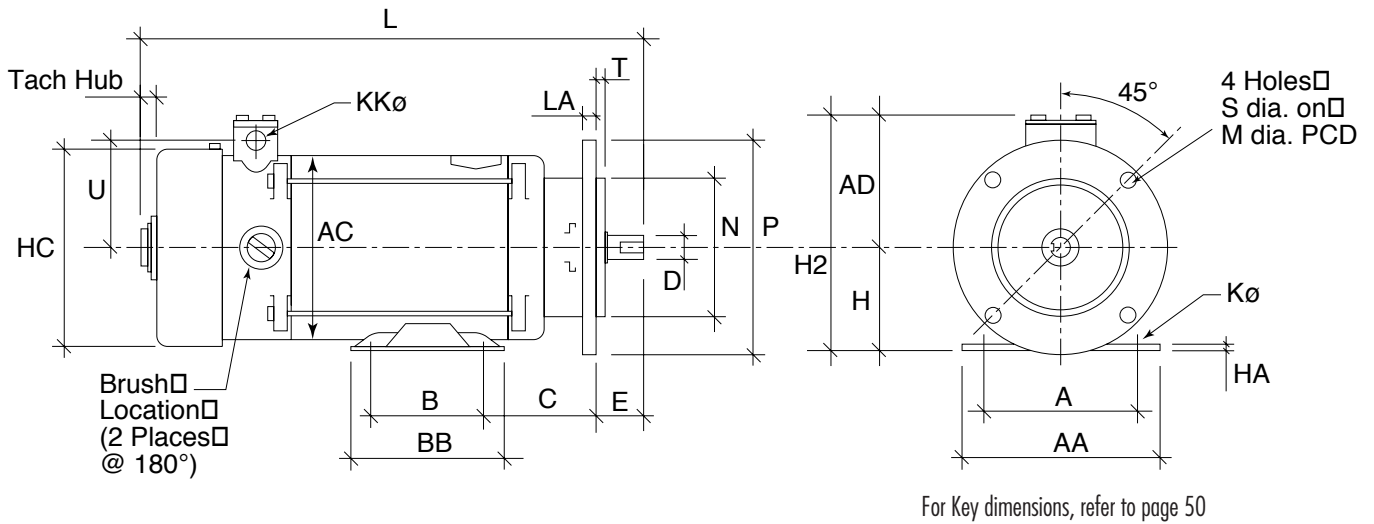

Type 3600P Motors

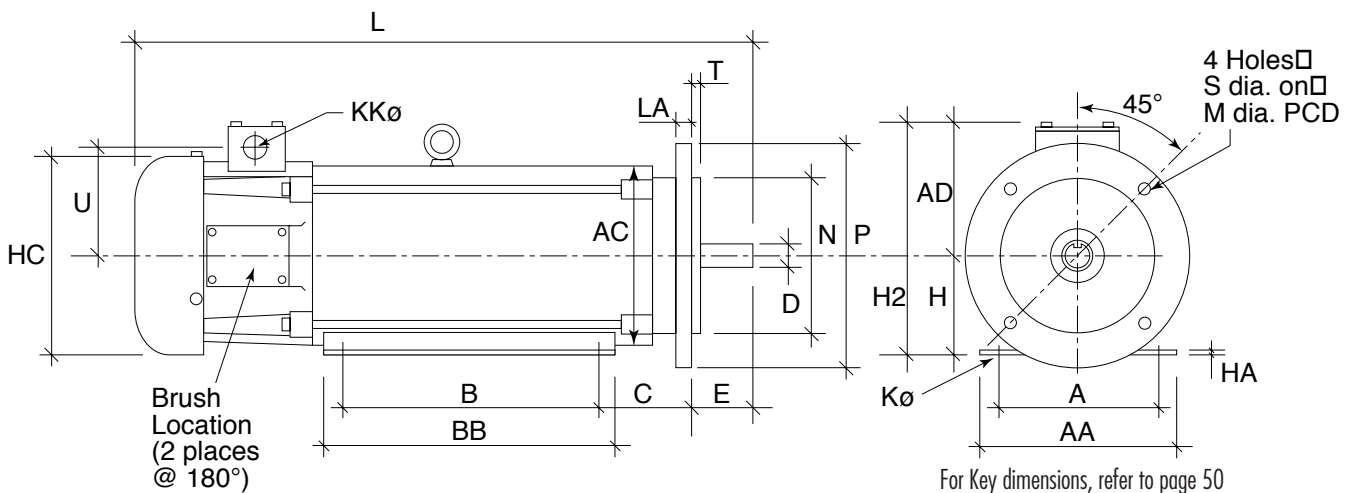

dc PM Motor Dimensions IEC Frame, B5 Flange Mount Motor Type 135, 3300P, 3400P, 3500P and 3600P

For more detailed drawings, please contact a Baldor office.

Type	Base rpm	Frame	Flange						Conduit Box			General Motor			Bearings	
			M	N	P	S	LA	T	KK	AD	U	AC	H2	HC	ODE	DE
135	1750	D63	115	95	100(SQ)	10	8.8	3	NA	NA	NA	86	NA	NA	R8	6000
3320P	1750	D63	115	95	140	10	10	3	22	116	91	119	179	NA	6203	6203
3320P	3000	D71	130	110	160	10	8	3.5	22	116	91	119	205	NA	6203	6203
3327P	3000	D71	130	110	160	10	8	3.5	22	116	91	119	205	NA	6203	6203
3336P	1750	D71	130	110	160	10	8	3.5	22	116	91	119	205	NA	6203	6203
3420P	3000	D71	130	110	160	10	10	3.5	PG16	102	77	145	178	158	6203	6203
3420P	3000	D80	165	130	200	12	12	3.5	PG16	102	77	145	191	158	6203	6206
3428P	1750	D71	130	110	160	10	10	3.5	PG16	102	77	145	178	158	6203	6203
3428P	1750	D80	165	130	200	12	12	3.5	PG16	102	77	145	191	158	6203	6206
3428P	3000	D80	165	130	200	12	12	3.5	PG16	102	77	145	191	158	6203	6206
3435P	1750	D80	165	130	200	12	12	3.5	PG16	102	77	145	191	158	6203	6206
3435P	3000	D90	165	130	200	12	12	3.5	PG16	102	77	145	191	158	6205	6206
3536P	1750/3000	D90	165	130	200	12	12	3.5	PG16	108	86	168	197	183	6205	6206
3548P	1750	D90	165	130	200	12	12	3.5	PG16	108	86	168	197	183	6205	6206
3649P	1750	D100	215	180	248	14	14	4	25	154	125	200	268	225	6206	6206
3681P	1750	D112	215	180	248	14	14	4	25	150	122	200	264	225	6206	6206

Type	Base rpm	Frame	Foot Mounting								Shaft						
			L	Tach Hub	A*	B*	AA*	BB*	K	HA	C*	H*	D	E	b	h	TAP
135	1750	D63	180	NONE	102	76	124	99	7 Slot (4)	5	38	62	11	23	4	4	M4
3320P	1750	D63	279	NONE	100	80	119	99	7 Slot (4)	5	54	63	11	23	4	4	M4
3320P	3000	D71	321	30	124	76	165	114	9 Slot (4)	5	97	71	14	30	5	5	M5x0.8
3327P	3000	D71	345	30	124	76	165	114	9 Slot (4)	5	97	71	14	30	5	5	M5x0.8
3336P	1750	D71	390	30	124	76	165	114	9 Slot (4)	5	97	71	14	30	5	5	M5x0.8
3420P	3000	D71	372	20	108	70	146	102	9 Slot (4)	5	92	76	14	30	5	5	M5x0.8
3420P	3000	D80	399	20	124	76	171	140	9 Slot (6)	6.4	106	89	19	40	6	6	M6x1
3428P	1750	D71	372	20	108	70	146	102	9 Slot (4)	5	92	76	14	30	5	5	M5x0.8
3428P	1750	D80	399	20	124	102	146	140	9 Slot (6)	6.4	106	89	19	40	6	6	M6x1
3428P	3000	D80	399	20	124	102	171	140	9 Slot (6)	6.4	106	89	19	40	6	6	M6x1
3435P	1750	D80	422	20	124	102	171	140	9 Slot (6)	6.4	106	89	19	40	6	6	M6x1
3435P	3000	D90	432	20	124	102	171	140	9 Slot (6)	6.4	106	89	24	50	8	7	M8x1.25
3536P	1750/3000	D90	454	20	124	76	165	114	9 Slot (4)	4	95	89	24	50	8	7	M8x1.25
3548P	1750	D90	480	20	124	76	165	114	9 Slot (4)	4	95	89	24	50	8	7	M8x1.25
3649P	1750	D100	643	NONE	191	140	219	165	10 Slot (6)	4	114	114	28	60	8	7	M10x1.5
3681P	1750	D112	745	NONE	191	280	219	330	10 Slot (12)	4	114	114	28	60	8	7	M10x1.5

Dimensions marked with * DO NOT comply with IEC standards.

